

R7M-A□, R7M-AP□

# SmartStep servo motors

## The smart alternative to stepper motors

- SmartStep motors can be controlled by SmartStep drive and XtraDrive
- Cylindrical and flat servo motor types are available
- Easy to setup, easy to operate. SmartStep is as easy to use as a stepper motor
- Front-panel switches in the SmartStep drive make settings easy and eliminate the need for time-consuming parameter settings
- Extended features and embedded in drive control can be provided using intelligent XtraDrive
- Models with brake available
- Easy to connect to the drive using prebuilt cables



## Ratings

- 230 VAC from 30 W to 750 W  
(0.095 Nm to 2.39 Nm)

## System configuration

(Refer to servo drive chapter)



Servo Drive controlled by pulses

**SmartStep Servo Drive**

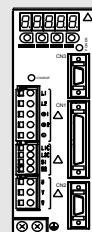

Intelligent Servo Drive

**XtraDrive**

Drive options

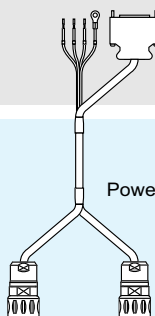

Power and encoder cables

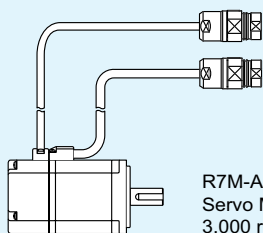

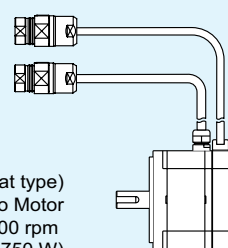

**R7M-A (cylindrical type) Servo Motor**  
3,000 rpm  
(30-750 W)



**R7M-AP (flat type) Servo Motor**  
3,000 rpm  
(100-750 W)

**Servo motor / servo drive combination**

| SmarStep servo motor   |         |              |          | SmartStep servo drive |  | XtraDrive servo drive |  |
|--|---------|--------------|----------|-----------------------|--|-----------------------|--|
|  | Voltage | Rated torque | Capacity | Model                 |  | 230 V (1-phase)       |  |
| <br>R7M-A (3000 min <sup>-1</sup> ) | 230 V   | 0.095 Nm     | 30 W     | R7M-A03030-□          |  | R7D-APA3H             |  |
|  |         | 0.159 Nm     | 50 W     | R7M-A05030-□          |  | R7D-APA5H             |  |
|  |         | 0.318 Nm     | 100 W    | R7M-A10030-□          |  | R7D-AP01H             |  |
|  |         | 0.637 Nm     | 200 W    | R7M-A20030-□          |  | R7D-AP02H             |  |
|  |         | 1.27 Nm      | 400 W    | R7M-A40030-□          |  | R7D-AP04H             |  |
|  |         | 2.39 Nm      | 750 W    | R7M-A75030-□          |  | R7D-AP08H             |  |
| <br>R7M-AP(3000 min <sup>-1</sup> ) | 230 V   | 0.318 Nm     | 100 W    | R7M-AP10030-□         |  | R7D-AP01H             |  |
|  |         | 0.637 Nm     | 200 W    | R7M-AP20030-□         |  | R7D-AP02H             |  |
|  |         | 1.27 Nm      | 400 W    | R7M-AP40030-□         |  | R7D-AP04H             |  |
|  |         | 2.39 Nm      | 750 W    | R7M-AP75030-□         |  | R7D-AP08H             |  |

**Note:** 1. For servo motor and cable part numbers, refer to ordering information at the end of this chapter.  
 2. Refer to the servo drive chapter for drive options selection and detailed specifications.

**Servo motor specifications**

**General specifications**

| Item                          | Specification   |
|-------------------------------|---|
| Ambient operating temperature | 0 to 40 °C  |
| Ambient operating humidity    | 20% to 80% (with no condensation)   |
| Ambient storage temperature   | -20 to 60 °C  |
| Ambient storage humidity      | 20% to 80% (with no condensation)   |
| Storage/operating atmosphere  | No corrosive gases.   |
| Vibration resistance          | 10 to 2,500 Hz in X, Y, and Z directions with 0.2 mm double amplitude or acceleration of 24.5 m/s <sup>2</sup> max., whichever is smaller |
| Impact resistance             | Acceleration 98 m/s <sup>2</sup> max., in a vertical direction, two times   |
| Insulation resistance         | Between power line terminals and FG: 10 MΩ min. (at 500 VDC)  |
| Dielectric strength           | Between power line terminals and FG: 1,500 VAC for 1 min at 50/60 Hz  |
| Run position                  | Any direction   |
| Insulation grade              | Type B  |
| Structure                     | Totally-enclosed self-cooling   |
| Protective structure          | IP55 for both the cylindrical and flat servo motors   |
| Vibration grade               | V-15  |
| Mounting method               | Flange-mounting   |
| International standards       | Approval obtained for UL, cUL, and EN (EMC directive and low-voltage directive)   |

**Performance specifications**

**Flat servo motors**

| Item                             | R7M-AP10030-□   | R7M-AP20030-□                             | R7M-AP40030-□                             | R7M-AP75030-□                             |              |
|----------------------------------|---|---|---|---|--------------|
| Rated output                     | 100 W   | 200 W                                     | 400 W                                     | 750 W                                     |              |
| Rated torque                     | 0.318 N·m   | 0.637 N·m                                 | 1.27 N·m                                  | 2.39 N·m                                  |              |
| Rated rotation speed             | 3,000 r/min   | 3,000 r/min                               | 3,000 r/min                               | 3,000 r/min                               |              |
| Momentary maximum rotation speed | 4,500 r/min   | 4,500 r/min                               | 4,500 r/min                               | 4,500 r/min                               |              |
| Momentary maximum torque         | 0.96 N·m  | 1.91 N·m                                  | 3.82 N·m                                  | 7.1 N·m                                   |              |
| Rated current                    | 0.89 A (rms)  | 2.0 A (rms)                               | 2.6 A (rms)                               | 4.1 A (rms)                               |              |
| Momentary maximum current        | 2.8 A (rms)   | 6.0 A (rms)                               | 8.0 A (rms)                               | 13.9 A (rms)                              |              |
| Rotor inertia                    | 6.5 × 10 <sup>-6</sup> kg·m <sup>2</sup>  | 2.09 × 10 <sup>-5</sup> kg·m <sup>2</sup> | 3.47 × 10 <sup>-5</sup> kg·m <sup>2</sup> | 2.11 × 10 <sup>-4</sup> kg·m <sup>2</sup> |              |
| Power rate                       | 15.7 kW/s   | 19.4 kW/s                                 | 46.8 kW/s                                 | 26.9 kW/s                                 |              |
| Allowable radial load            | 78 N  | 245 N                                     | 245 N                                     | 392 N                                     |              |
| Allowable thrust load            | 49 N  | 68 N                                      | 68 N                                      | 147 N                                     |              |
| Weight                           | Without brake   | 0.7 kg                                    | 1.4 kg                                    | 2.1 kg                                    |              |
|                                  | With brake  | 0.9 kg                                    | 1.9 kg                                    | 2.6 kg                                    |              |
| Encoder resolution               | 2,000 pulses/revolution for phase-A and phase-B, 1 pulse/revolution for phase-Z |   |   |   |              |
| Radiation shield dimensions      | t6 × 250 mm square  |   |   | t12 × 300 mm square                       |              |
| Brake specifications             | Brake inertia   | 3.1 × 10 <sup>-6</sup> kg·m <sup>2</sup>  | 1.52 × 10 <sup>-5</sup> kg·m <sup>2</sup> | 1.52 × 10 <sup>-5</sup> kg·m <sup>2</sup> |              |
|                                  | Excitation voltage  | 24 VDC ±10%                               |   |   |              |
|                                  | Power consumption (at 20 °C)  | 7.5 W                                     | 7.6 W                                     | 8.2 W                                     | 7.5 W        |
|                                  | Current consumption (at 20 °C)  | 0.31 A                                    | 0.32 A                                    | 0.34 A                                    | 0.31 A       |
|                                  | Static friction torque  | 0.4 N·m min.                              | 0.9 N·m min.                              | 1.9 N·m min.                              | 3.5 N·m min. |
|                                  | Attraction time   | 60 ms max.                                | 40 ms max.                                | 60 ms max.                                | 20 ms max.   |
|                                  | Release time  | 20 ms max.                                | 20 ms max.                                | 20 ms max.                                | 40 ms max.   |
|                                  | Backlash  | 1°  | 1°  | 1°  | 1°           |
|                                  | Rating  | Continuous                                |   |   |              |
|                                  | Insulation grade  | Type F                                    |   |   |              |
| Applicable servo driver (R7D-)   | AP01H   | AP02H                                     | AP04H                                     | AP08H                                     |              |

Cylindrical servo motors

| Item                             | R7M-A03030-□  | R7M-A05030-□                            | R7M-A10030-□                            | R7M-A20030-□                            | R7M-A40030-□                            | R7M-A75030-□                            |  |
|----------------------------------|---|---|---|---|---|---|--|
| Rated output                     | 30 W  | 50 W                                    | 100 W                                   | 200 W                                   | 400 W                                   | 750 W                                   |  |
| Rated torque                     | 0.095 N·m   | 0.159 N·m                               | 0.318 N·m                               | 0.637 N·m                               | 1.27 N·m                                | 2.39 N·m                                |  |
| Rated rotation speed             | 3,000 r/min   | 3,000 r/min                             | 3,000 r/min                             | 3,000 r/min                             | 3,000 r/min                             | 3,000 r/min                             |  |
| Momentary maximum rotation speed | 4,500 r/min   | 4,500 r/min                             | 4,500 r/min                             | 4,500 r/min                             | 4,500 r/min                             | 4,500 r/min                             |  |
| Momentary maximum torque         | 0.29 N·m  | 0.48 N·m                                | 0.96 N·m                                | 1.91 N·m                                | 3.82 N·m                                | 7.1 N·m                                 |  |
| Rated current                    | 0.42 A (rms)  | 0.6 A (rms)                             | 0.87 A (rms)                            | 2.0 A (rms)                             | 2.6 A (rms)                             | 4.4 A (rms)                             |  |
| Momentary maximum current        | 1.3 A (rms)   | 1.9 A (rms)                             | 2.8 A (rms)                             | 6.0 A (rms)                             | 8.0 A (rms)                             | 13.9 A (rms)                            |  |
| Rotor inertia                    | $1.7 \times 10^{-6}$ kg·m <sup>2</sup>  | $2.2 \times 10^{-6}$ kg·m <sup>2</sup>  | $3.6 \times 10^{-6}$ kg·m <sup>2</sup>  | $1.19 \times 10^{-5}$ kg·m <sup>2</sup> | $1.87 \times 10^{-5}$ kg·m <sup>2</sup> | $6.67 \times 10^{-5}$ kg·m <sup>2</sup> |  |
| Power rate                       | 5.31 kW/s   | 11.5 kW/s                               | 28.1 kW/s                               | 34.1 kW/s                               | 86.3 kW/s                               | 85.6 kW/s                               |  |
| Allowable radial load            | 68 N  | 68 N                                    | 78 N                                    | 245 N                                   | 245 N                                   | 392 N                                   |  |
| Allowable thrust load            | 54 N  | 54 N                                    | 54 N                                    | 74 N                                    | 74 N                                    | 147 N                                   |  |
| Weight                           | Without brake   | 0.3 kg                                  | 0.4 kg                                  | 0.5 kg                                  | 1.1 kg                                  | 1.7 kg                                  | 3.4 kg                                 |
|                                  | With brake  | 0.6 kg                                  | 0.7 kg                                  | 0.8 kg                                  | 1.6 kg                                  | 2.2 kg                                  | 4.3 kg                                 |
| Encoder resolution               | 2,000 pulses/revolution for phase-A and phase-B, 1 pulse/revolution for phase-Z |   |   |   |   |   |  |
| Radiation shield dimensions      | t6 × 250 mm square  |   |   |   |   |   |  |
| Brake specifications             | Brake inertia   | $0.85 \times 10^{-6}$ kg·m <sup>2</sup> | $0.85 \times 10^{-6}$ kg·m <sup>2</sup> | $0.85 \times 10^{-6}$ kg·m <sup>2</sup> | $6.4 \times 10^{-6}$ kg·m <sup>2</sup>  | $6.4 \times 10^{-6}$ kg·m <sup>2</sup>  | $1.7 \times 10^{-5}$ kg·m <sup>2</sup> |
|                                  | Excitation voltage  | 24 VDC ±10% V                           |   |   |   |   |  |
|                                  | Power consumption (at 20 °C)  | 6 W                                     | 6 W                                     | 6 W                                     | 7 W                                     | 7 W                                     | 7.7 W                                  |
|                                  | Current consumption (at 20 °C)  | 0.25 A                                  | 0.25 A                                  | 0.25 A                                  | 0.29 A                                  | 0.29 A                                  | 0.32 A                                 |
|                                  | Static friction torque  | 0.2 N·m min.                            | 0.2 N·m min.                            | 0.34 N·m min.                           | 1.47 N·m min.                           | 1.47 N·m min.                           | 2.45 N·m min.                          |
|                                  | Attraction time   | 30 ms max.                              | 30 ms max.                              | 30 ms max.                              | 60 ms max.                              | 60 ms max.                              | 60 ms max.                             |
|                                  | Release time  | 60 ms max.                              | 60 ms max.                              | 60 ms max.                              | 20 ms max.                              | 20 ms max.                              | 20 ms max.                             |
|                                  | Backlash  | 1°                                      | 1°                                      | 1°                                      | 1°                                      | 1°                                      | 1°                                     |
|                                  | Rating  | Continuous                              | Continuous                              | Continuous                              | Continuous                              | Continuous                              | Continuous                             |
| Insulation grade                 | Type F  | Type F                                  | Type F                                  | Type F                                  | Type F                                  | Type F                                  |  |
| Applicable servo driver (R7D-)   | APA3H   | APA5H                                   | AP01H                                   | AP02H                                   | AP04H                                   | AP08H                                   |  |

Torque and rotation speed characteristics

Flat servo motors

The following graphs show the characteristics with a 3 m standard cable and R7D-AP□H servo driver (200 VAC input)

R7M-AP10030 (100 W)

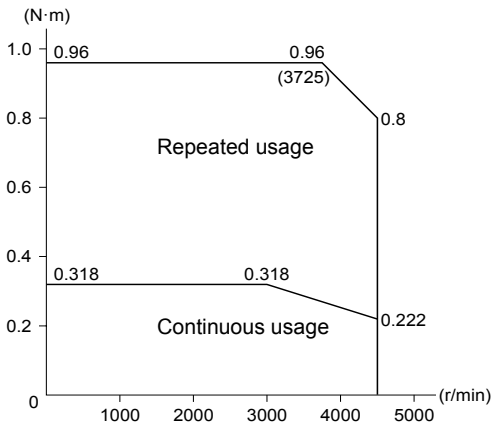

R7M-AP20030 (200 W)

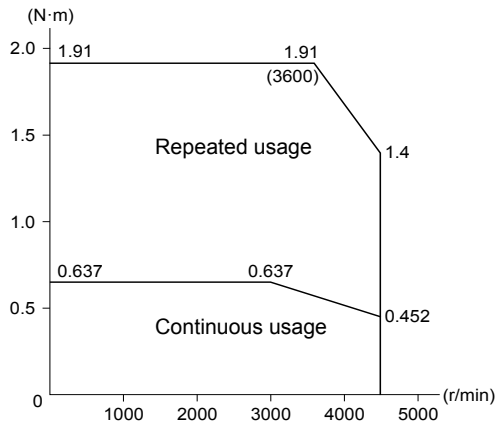

R7M-AP40030 (400 W)

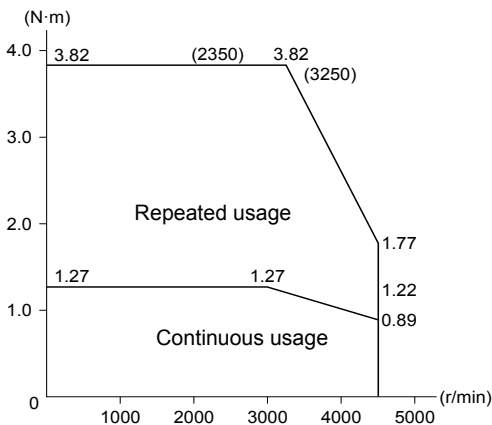

R7M-AP75030 (750 W)

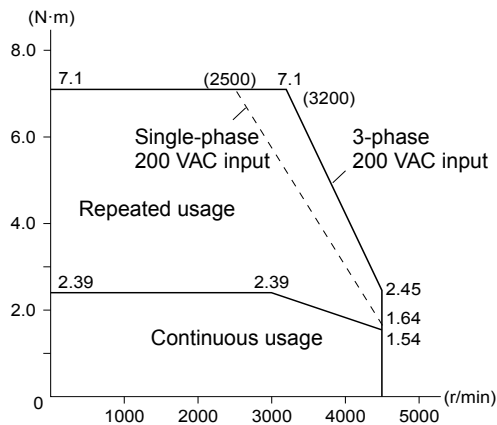



**Torque and rotation speed characteristics**

**Cylindrical servo motors**

The following graphs show the characteristics with a 3 m standard cable and an R7D-AP□H servo driver (200 VAC input.)

**R7M-A03030 (30 W)**

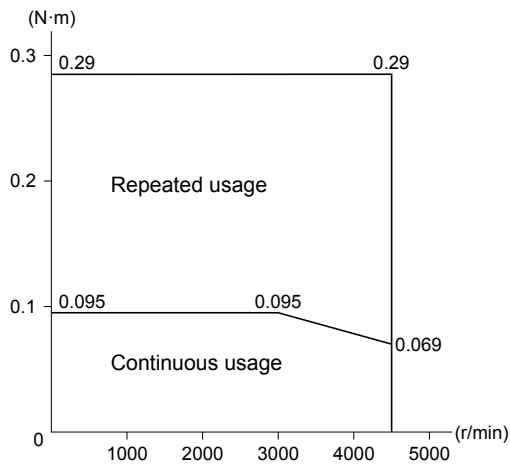

**R7M-A05030 (50 W)**

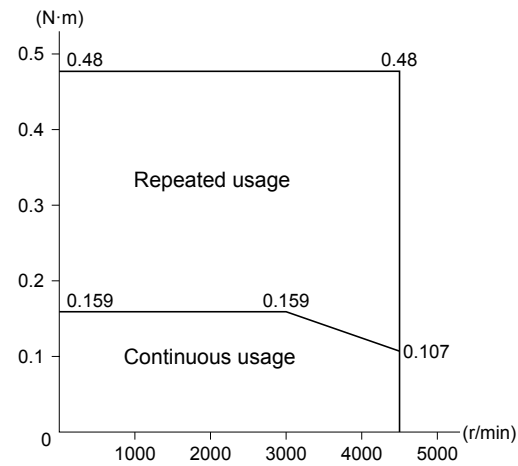

**R7M-A10030 (100 W)**

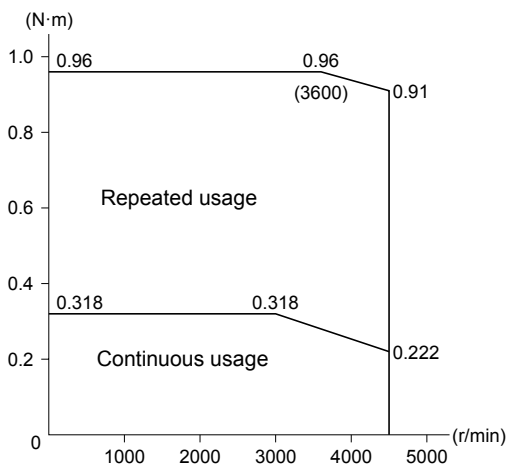

**R7M-A20030 (200 W)**

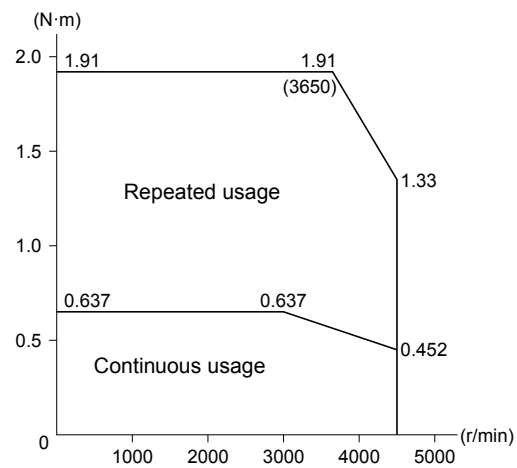

**R7M-A40030 (400 W)**

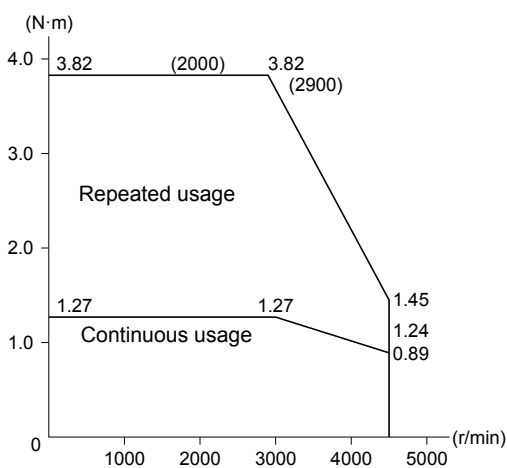

**R7M-A75030 (750 W)**

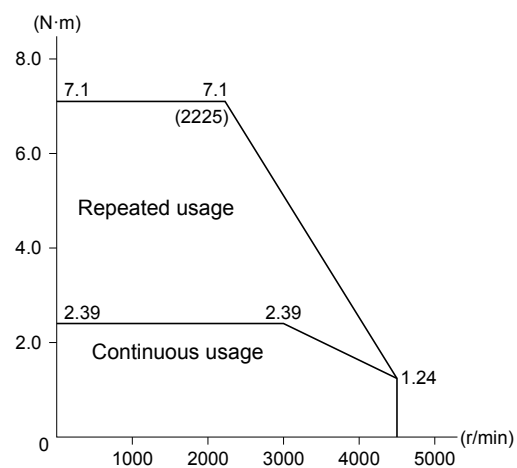

**Dimensions**

Cylindrical servo motors (3,000 r/min)  
200 VAC: 30W/50W/100W/200W/400W/750W

Without brake: R7M-A03030-S1-D/A05030-S1-D/A10030-S1-D/A20030-S1-D/A40030-S1-D/A75030-S1-D  
With brake: R7M-A03030-BS1-D/A05030-BS1-D/A10030-BS1-D/A20030-BS1-D/A40030-BS1-D/A75030-BS1-D

| Model       | Dimensions (mm) |            |      |                |      |      |     |    |               |          |      |              |      |                |
|-------------|-----------------|------------|------|----------------|------|------|-----|----|---------------|----------|------|--------------|------|----------------|
|             | LL              |            | LR   | Flange surface |      |      |     |    |               | Axis end |      |              |      |                |
|             | Without brake   | With brake |      | C              | D1   | D2   | F   | G  | Z             | S        | QK   | b            | h    | t1             |
| R7M-A03030□ | 69.5            | 101        | 25   | 40             | 46   | 30h7 | 2.5 | 5  | Two, 4.3 dia. | 6h6      | 14   | 2            | 2    | 1.2            |
| R7M-A05030□ | 77              | 108.5      |      | 8h6            | 3    | 3    | 1.8 |    |               |          |      |              |      |                |
| R7M-A10030□ | 94.5            | 135        |      |                |      |      |     | 30 | 60            | 70       | 50h7 | 3            | 6    | Four, 5.5 dia. |
| R7M-A20030□ | 96.5            | 136        | 14h6 | 20             |      |      |     |    |               |          |      |              |      |                |
| R7M-A40030□ | 124.5           | 164        |      |                | 16h6 | 30   |     |    |               |          |      |              |      |                |
| R7M-A75030□ | 145             | 189.5      | 40   | 80             |      |      | 90  |    | 70h7          | 3        | 8    | Four, 7 dia. | 16h6 | 30             |

R7M-A□□□30-S1-D (Without brake)

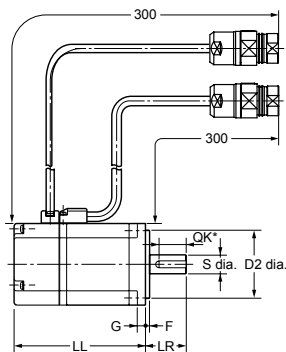

R7M-A□□□30-BS1-D (With brake)

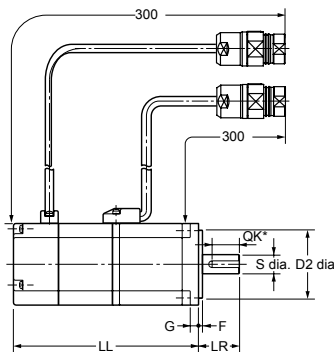

Axis end dimensions

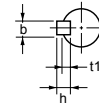

Hole with "Z" mark

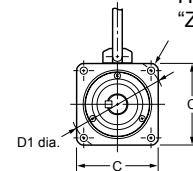

Flat servo motors (3,000 r/min)  
200 VAC: 100W/200W/400W/750W

Without brake: R7M-AP10030-S1-D/AP20030-S1-D/AP40030-S1-D/AP75030-S1-D  
With brake: R7M-AP10030-BS1-D/AP20030-BS1-D/AP40030-BS1-D/AP75030-BS1-D

| Model        | Dimensions (mm) |            |    |                |     |       |     |    |     |          |    |   |   |     |
|--------------|-----------------|------------|----|----------------|-----|-------|-----|----|-----|----------|----|---|---|-----|
|              | LL              |            | LR | Flange surface |     |       |     |    |     | Axis End |    |   |   |     |
|              | Without brake   | With brake |    | C              | D1  | D2    | F   | G  | Z   | S        | QK | b | h | t1  |
| R7M-AP10030□ | 62              | 91         | 25 | 60             | 70  | 50h7  | 3   | 6  | 5.5 | 8h6      | 14 | 3 | 3 | 1.8 |
| R7M-AP20030□ | 67              | 98.5       | 30 | 80             | 90  | 70h7  | 3   | 8  | 7   | 14h6     | 16 | 5 | 5 | 3   |
| R7M-AP40030□ | 87              | 118.5      | 40 | 120            | 145 | 110h7 | 3.5 | 10 | 10  | 16h6     | 22 |   |   |     |
| R7M-AP75030□ | 86.5            | 120        |    |                |     |       |     |    |     |          |    |   |   |     |

R7M-AP□□□30-S1-D (Without brake)

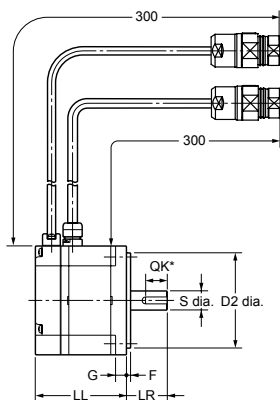

R7M-AP□□□30-BS1-D (With brake)

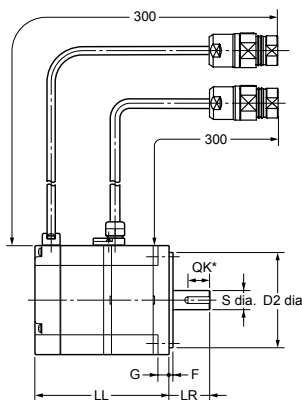

Axis end dimensions

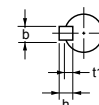

Four, Z-dia. mounting holes

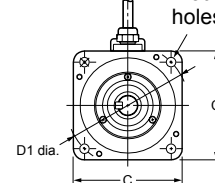

**Ordering information**

(Refer to servo drive chapter)

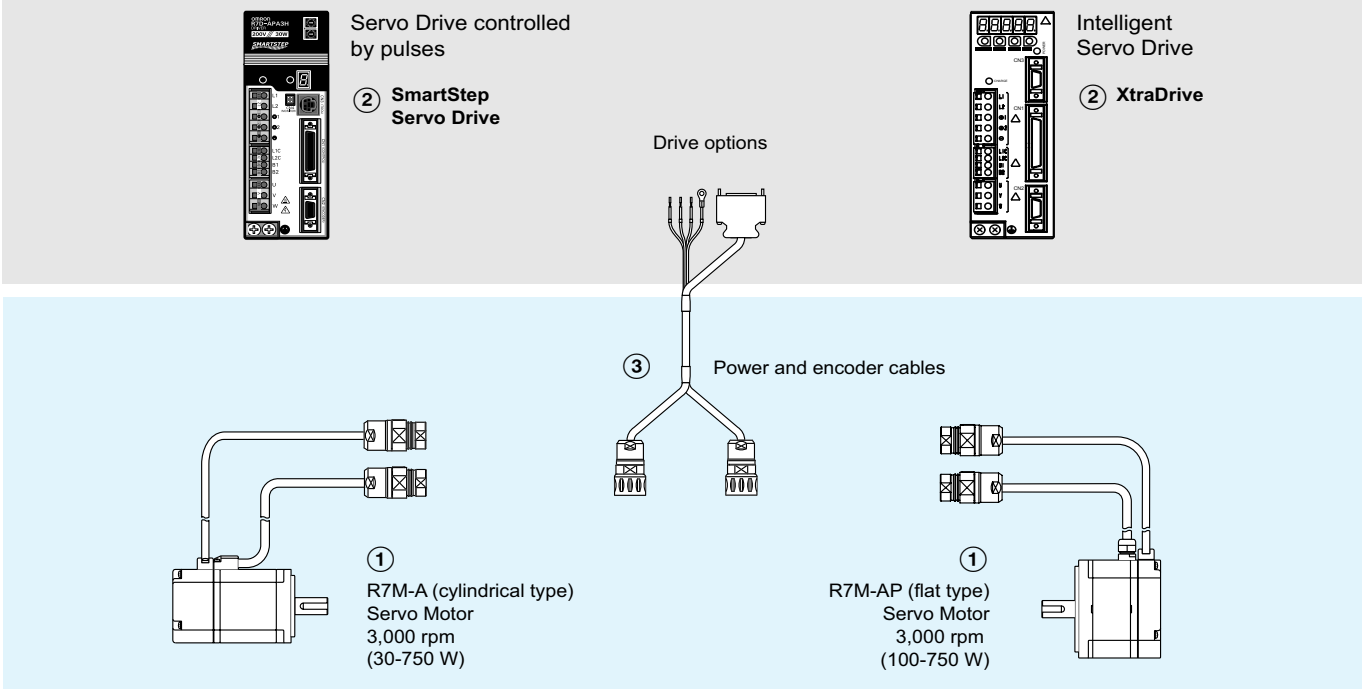

**Note:** The symbols ①②③... show the recommended sequence to select the servo motor and cables.

**Servo motor**

**Cylindrical servo motors (3,000-r/min)**

| Symbol | Specifications  |               |          | Servo motor model | Compatible servo drives ② |           |            |
|--------|---|---------------|----------|-------------------|---------------------------|-----------|------------|
|        | Design  | Rated torque  | Capacity |                   | SmartStep                 | XtraDrive |            |
| ①      | Cylindrical servo motors (3,000-r/min)<br>Straight shaft with key | Without brake | 0.095 Nm | 30 W              | R7M-A03030-S1-D           | R7D-APA3H | XD-P3-MN01 |
|        |   |               | 0.159 Nm | 50 W              | R7M-A05030-S1-D           | R7D-APA5H | XD-P5-MN01 |
|        |   |               | 0.318 Nm | 100 W             | R7M-A10030-S1-D           | R7D-AP01H | XD-01-MN01 |
|        |   |               | 0.637 Nm | 200 W             | R7M-A20030-S1-D           | R7D-AP02H | XD-02-MN01 |
|        |   |               | 1.27 Nm  | 400 W             | R7M-A40030-S1-D           | R7D-AP04H | XD-04-MN01 |
|        |   |               | 2.39 Nm  | 750 W             | R7M-A75030-S1-D           | R7D-AP08H | XD-08-MN   |
|        |   | With brake    | 0.095 Nm | 30 W              | R7M-A03030-BS1-D          | R7D-APA3H | XD-P3-MN01 |
|        |   |               | 0.159 Nm | 50 W              | R7M-A05030-BS1-D          | R7D-APA5H | XD-P5-MN01 |
|        |   |               | 0.318 Nm | 100 W             | R7M-A10030-BS1-D          | R7D-AP01H | XD-01-MN01 |
|        |   |               | 0.637 Nm | 200 W             | R7M-A20030-BS1-D          | R7D-AP02H | XD-02-MN01 |
|        |   |               | 1.27 Nm  | 400 W             | R7M-A40030-BS1-D          | R7D-AP04H | XD-04-MN01 |
|        |   |               | 2.39 Nm  | 750 W             | R7M-A75030-BS1-D          | R7D-AP08H | XD-08-MN   |

**Flat servo motors (3,000-r/min)**

| Symbol | Specifications   |               |            | Servo motor model | Compatible servo drives ② |                   |            |            |
|--------|--|---------------|------------|-------------------|---------------------------|-------------------|------------|------------|
|        | Design   | Rated torque  | Capacity   |                   | SmartStep                 | XtraDrive         |            |            |
| ①      | Flat servo motors (3,000-r/min)<br>Straight shaft with key | Without brake | 0.318 Nm   | 100 W             | R7M-AP10030-S1-D          | R7D-AP01H         | XD-01-MN01 |            |
|        |  |               | 0.637 Nm   | 200 W             | R7M-AP20030-S1-D          | R7D-AP02H         | XD-02-MN01 |            |
|        |  |               | 1.27 Nm    | 400 W             | R7M-AP40030-S1-D          | R7D-AP04H         | XD-04-MN01 |            |
|        |  |               | 2.39 Nm    | 750 W             | R7M-AP75030-S1-D          | R7D-AP08H         | XD-08-MN   |            |
|        |  |               | With brake | 0.318 Nm          | 100 W                     | R7M-AP10030-BS1-D | R7D-AP01H  | XD-01-MN01 |
|        |  |               |            | 0.637 Nm          | 200 W                     | R7M-AP20030-BS1-D | R7D-AP02H  | XD-02-MN01 |
|        |  | 1.27 Nm       |            | 400 W             | R7M-AP40030-BS1-D         | R7D-AP04H         | XD-04-MN01 |            |
|        |  | 2.39 Nm       |            | 750 W             | R7M-AP75030-BS1-D         | R7D-AP08H         | XD-08-MN   |            |

**Servo drive**

**Note:** Choosing SmartStep drive or XtraDrive affects to the encoder cable needed.

② Refer to SmartStep servo drive or XtraDrive chapter for detailed drive specifications and selection of drive accessories.

Servo motor cables for SmartStep drive

Standard cable (power + encoder)

| Symbol | Drive     | Specifications                                       | Power cable model | Encoder cable model | Appearance |
|--------|-----------|--|-------------------|---------------------|------------|
| ③      | SmartStep | For servo motors without brake<br>R7M-A(P)□□□30-S1-D | 3 m               | R7A-CEA003S-DE      |            |
|        |           |  | 5 m               | R7A-CEA005S-DE      |            |
|        |           |  | 10 m              | R7A-CEA010S-DE      |            |
|        |           |  | 15 m              | R7A-CEA015S-DE      |            |
|        |           |  | 20 m              | R7A-CEA020S-DE      |            |
|        |           | For servo motors with brake<br>R7M-A(P)□□□30-BS1-D   | 3 m               | R7A-CEA003B-DE      |            |
|        |           |  | 5 m               | R7A-CEA005B-DE      |            |
|        |           |  | 10 m              | R7A-CEA010B-DE      |            |
|        |           |  | 15 m              | R7A-CEA015B-DE      |            |
|        |           |  | 20 m              | R7A-CEA020B-DE      |            |

Flexible cables (power + encoder)

| Symbol | Drive     | Specifications                                       | Power cable model | Encoder cable model | Appearance |
|--------|-----------|--|-------------------|---------------------|------------|
| ③      | SmartStep | For servo motors without brake<br>R7M-A(P)□□□30-S1-D | 3 m               | R88A-CAWA003S-DE    |            |
|        |           |  | 5 m               | R88A-CAWA005S-DE    |            |
|        |           |  | 10 m              | R88A-CAWA010S-DE    |            |
|        |           |  | 15 m              | R88A-CAWA015S-DE    |            |
|        |           |  | 20 m              | R88A-CAWA020S-DE    |            |
|        |           | For servo motors with brake<br>R7M-A(P)□□□30-BS1-D   | 3 m               | R88A-CAWA003B-DE    |            |
|        |           |  | 5 m               | R88A-CAWA005B-DE    |            |
|        |           |  | 10 m              | R88A-CAWA010B-DE    |            |
|        |           |  | 15 m              | R88A-CAWA015B-DE    |            |
|        |           |  | 20 m              | R88A-CAWA020B-DE    |            |

Servo motor cables for XtraDrive Drive

Flexible cables (power + encoder)

| Symbol | Drive     | Specifications                                       | Power cable model | Encoder cable model | Appearance |
|--------|-----------|--|-------------------|---------------------|------------|
| ③      | XtraDrive | For servo motors without brake<br>R7M-A(P)□□□30-S1-D | 3 m               | R88A-CAWA003S-DE    |            |
|        |           |  | 5 m               | R88A-CAWA005S-DE    |            |
|        |           |  | 10 m              | R88A-CAWA010S-DE    |            |
|        |           |  | 15 m              | R88A-CAWA015S-DE    |            |
|        |           |  | 20 m              | R88A-CAWA020S-DE    |            |
|        |           | For servo motors with brake<br>R7M-A(P)□□□30-BS1-D   | 3 m               | R88A-CAWA003B-DE    |            |
|        |           |  | 5 m               | R88A-CAWA005B-DE    |            |
|        |           |  | 10 m              | R88A-CAWA010B-DE    |            |
|        |           |  | 15 m              | R88A-CAWA015B-DE    |            |
|        |           |  | 20 m              | R88A-CAWA020B-DE    |            |

Connectors

| Specifications                                      | Model                  |
|---|------------------------|
| SmartStep connectors kit                            | Models included in kit |
| SmartStep encoder connector (for CN2)               | R7A-CNA01R             |
| Hypertac power connector female                     | SPOC-06K-FSDN169       |
| Hypertac encoder connector female                   | SPOC-17H-FRON169       |
| Hypertac power connector male (used in the motor)   | SRUC-06J-MSCN236       |
| Hypertac encoder connector male (used in the motor) | SRUC-17G-MRWN087       |

ALL DIMENSIONS SHOWN ARE IN MILLIMETERS.  
To convert millimeters into inches, multiply by 0.03937. To convert grams into ounces, multiply by 0.03527.